



# AVM565A



HD 1080P



External I/O



PoE



Solid Light



Mobile Surveillance

ETS



## 2MP 10X Solid Light IP Camera

### FEATURES

- **Solid Light** series featuring better overexposure prevention (Advanced Smart Light Control), automatic adjustment of image brightness, and longer lifetime of LEDs



- Zoom lens of f6.0 ~ 60mm with **10x optical zoom, 16x digital zoom and auto focus**, suitable for various monitoring environments
- **External alarm I/O device** connection



- **POE (Power-over-Ethernet)** support to eliminate the use of power cables and reduce installation costs
- **ONVIF (ONVIFS)** standard supported to simplify system integration
- IR LEDs built-in for **night surveillance** with max effective range up to 60 meters
- **Remote Surveillance**
  - **Fully compatible** with **iOS** and **Android** devices, and **Internet Explorer** on Windows operating system
  - Free PC program, **CMS Lite**, for 24CH devices monitoring on Windows operating system
  - **Push Video** available on your iOS and Android devices when used with Push Video NVR series.



## ○ SPECIFICATIONS

■ Network	
LAN Port	YES
LAN Speed	10/100 Based-T Ethernet
Supported Protocols	DDNS, PPPoE, DHCP, NTP, SNTP, TCP/IP, ICMP, SMTP, FTP, HTTP, RTP, RTSP, RTCP, IPv4, Bonjour, UPnP, DNS, UDP, IGMP, QoS, SNMP
Number of Online Users	10
Security	(1) Multiple user access levels with password (2) IP address filtering (3) Digest authentication
Remote Access	(1) Internet Explorer on Windows operating system (2) CMS Lite, 24CH CMS software for Windows operating system (3) EagleEyes on iOS & Android mobile devices
■ Video	
Video Compression	H.264 (Main Profile) / MJPEG
Resolution	1920 x 1080 / 1280 x 720 / 720 x 480 / 352 x 240
Frame Rate	NTSC:30, PAL:25
Multiple Video Streaming	4 (H.264, MJPEG)
■ General	
Image Sensor	1/2.9" SONY CMOS image sensor
Min Illumination	1 Lux / F2.0, 0 Lux (LED ON)
S/N Ratio	More than 48dB (AGC off)
Electronic Shutter	1/7.5 to 1/8000 sec
Lens	f6.0 ~ 60mm / F2.0 ~ 2.8 10X Optical Zoom, Auto Focus, Near focus limit 10cm (wide) or 80cm (tele) to infinity
Viewing Angle	1X: 47.3° (Horizontal) x 27.5° (Vertical) x 53.5° (Diagonal) 10X: 5.3° (Horizontal) x 3.0° (Vertical) x 6.1° (Diagonal)
IR LED	YES
IR Effective Range**	Default mode: up to 40 meters IR enhanced mode: up to 60 meters
IR Shift	YES
IRIS Mode	YES (Two stage)
POE	YES (IEEE 802.3af)
RAM	20MB
IP Rating	IP67
White Balance	ATW
AGC	Auto
WDR	DWDR
Operating Temperature	-25°C ~ 50°C
Operating Humidity	90% or less relative humidity
Power Source (±10%)	12V / 1A
Power Consumption	9W (Max)
Net Weight (kg)	2.1
■ Others	
Mobile Surveillance	iPad / iPhone / Android mobile device
ONVIF Compatible	YES (Profile S)
Event Notification	FTP / Email / SMS
External Alarm Device Connection	YES
Digital Pan / Tilt / Zoom	YES
Motion Detection	YES
RTC (real-time clock)	YES
Reset Default	YES
Minimum Web Browsing Requirements	<ul style="list-style-type: none"> <li>• Intel core i3 or higher, or equivalent AMD</li> <li>• 2GB RAM</li> <li>• AGP graphics card, Direct Draw, 32MB RAM</li> <li>• Windows 10, Windows 8, Windows 7, Windows Vista &amp; Windows XP, DirectX 9.0 or later</li> <li>• Internet Explorer 7.x or later (Windows Edge not supported)</li> </ul>



## ◉ DIMENSIONS

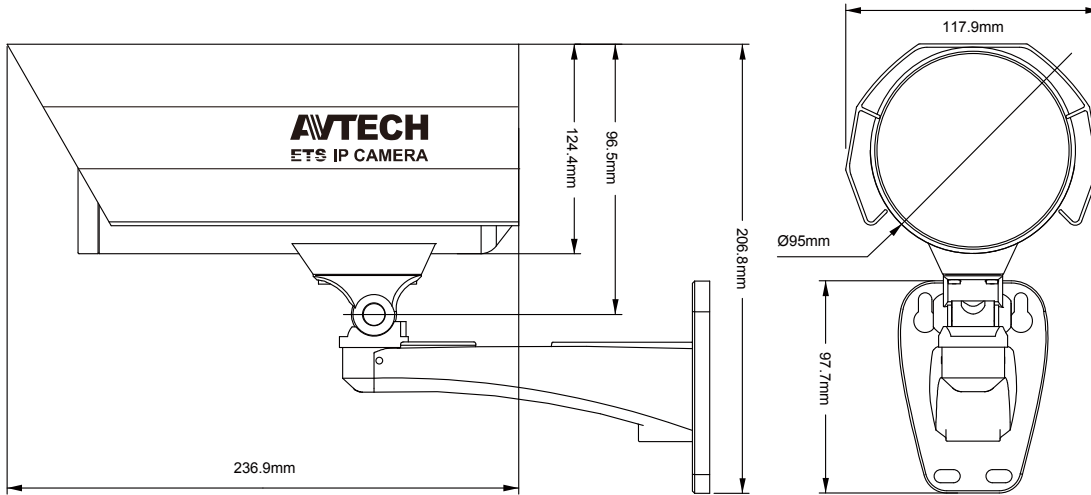

## ◉ OPTIONAL CONNECTOR

### ■ BULLETCON1

Used as a connector to install a junction box for further applications.

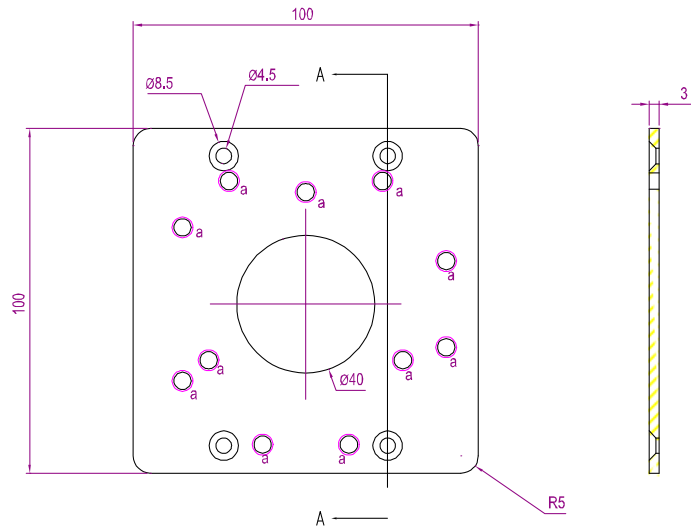

Dimensional tolerance: ± 5mm