

■ CAMERA INSTALLATION

■ TYPE1



▼ Standard package



Camera



Instructions



Accessories

▼ For selected models only



Rubber O-ring



Waterproof Seal

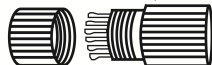

Plastic Tube Cover



Plastic Tube

Screws & wall plugs

Step1: Disassemble the camera case into three parts as illustrated in *Figure 1*.

Step2: Locate the base on the place you would like to install the camera; make sure the cable can be arranged properly in the base. (Refer to *Figure 2*)

Step3: Drill 4 holes and screw the base to the wall (or ceiling).

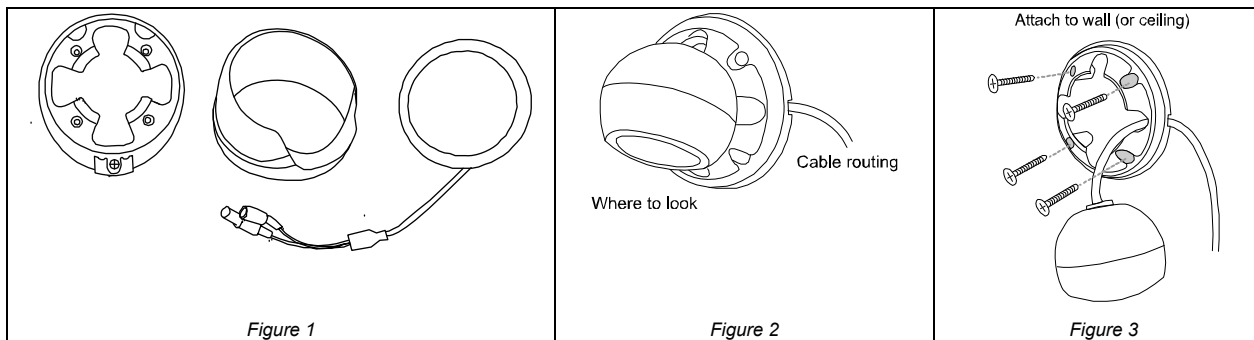

Step4: Put together the bracket and the lens, and slightly adjust the camera lens. Make sure it faces your target surveillance area.

Note: Do not install the lens opposite down. (Refer to *Figure5*)

Step5: Screw the base tight. (Refer to *Figure 6*).

Step6: Power on the camera and fine-tune the viewing angle.

For the motorized vari-focal type, please go to the section, “**ADJUST FOCAL LENGTH & FOCUS**”, to know how to adjust focal length and focus remotely.

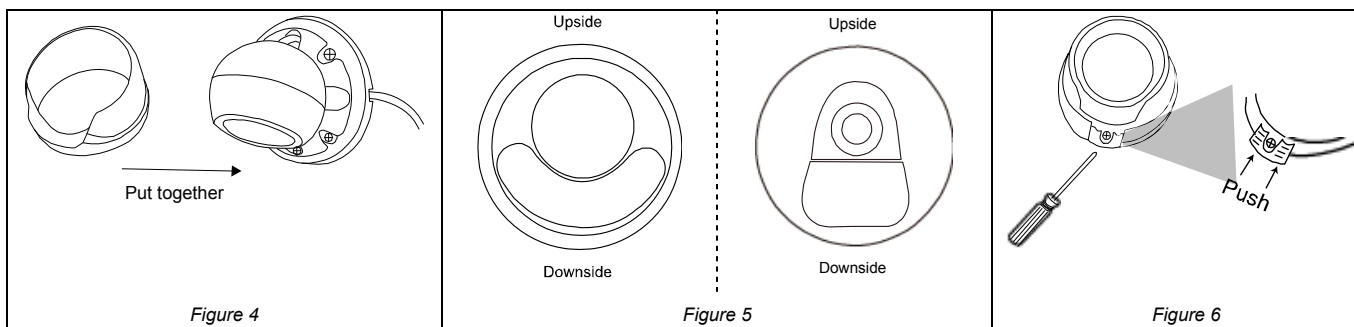

■ TYPE2



▼ Standard package



Camera

Installation
Guide

Instructions



Wrench



Screws, Wall Plugs,
Rubber Rings (×3)

SILICA GEL
DO NOT EAT

Desiccants



3-pin
terminal block



Rubber O-ring



Waterproof Seal



Plastic Tube Cover



Plastic Tube

Screws & wall plugs

Step1: Find the installation sticker on the sales package, and paste it to where you want to install this camera. Then, drill screw holes as indicated on the sticker (Figure 1).

Note: The installation sticker could also be downloaded from www.surveillance-download.com/user/542_installation_sticker.pdf.

Step2: Arrange the cables to be connected as shown in Figure 2 depending on the installation location for installation later.

Step3: Remove the dome cover by using the wrench supplied within the sales package, and find the three screw holes on the camera base.

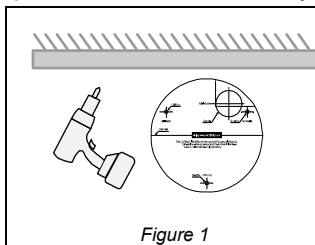

Figure 1

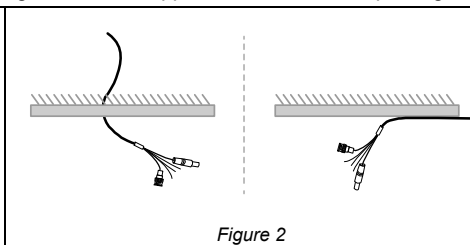

Figure 2

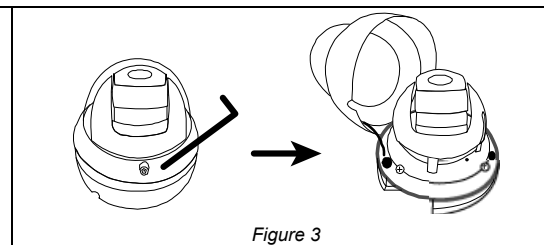

Figure 3

Step4: Connect the cables.

- A waterproof kit for RJ45 network cable might be provided in the sales package. Please check the section "**WATERPROOF KIT**" to know how to use it.
 - To connect alarm devices, a terminal block might be provided in the sales package. Please connect the terminal block first and start wiring.
- Then, align the screw holes on the camera base with the holes drilled in Step1, and install the camera.

Note: Three rubber rings are provided within the sales package. They should be used with the screws during installation for waterproof purposes.

Step5: Adjust the viewing angle of the camera.

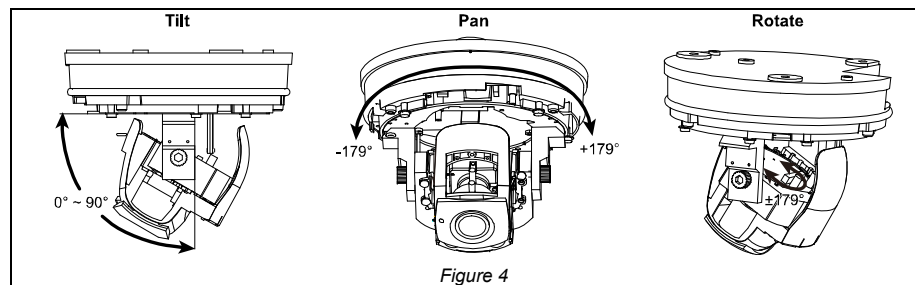

Figure 4

To adjust the angle vertically, remove the black shield as indicated in Figure 6, and rotate the knobs on both sides to loosen the tilt mechanism and move the lens. Then, secure the tilt mechanism by fasten the knobs to fix the angle.

Step6: Remove the desiccants in the camera, and replace it with the pack of desiccants supplied with the package to ensure the dryness inside the camera.

Step7: Find the mark as indicated below on both the dome cover and the camera base. Align these two marks to replace the dome cover back to the camera, as illustrated in Figure 7.

Note: Please wipe the inner part of the dome cover against the lens for clear images.

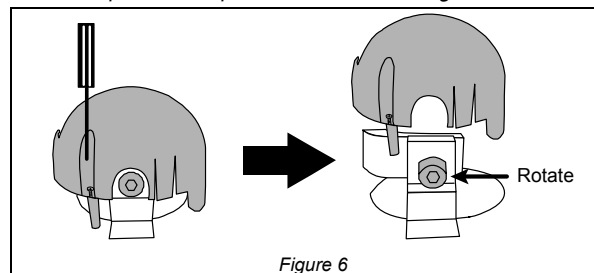

Figure 6

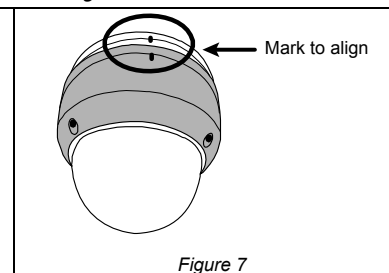
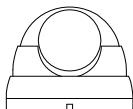

Figure 7

■ CAMERA INSTALLATION

■ TYPE3



▼ Standard package



Camera case

Installation
Guide

Instructions

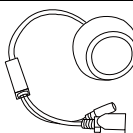

Camera



Screws &
wall plugs

▼ For selected models only



Rubber O-ring



Waterproof Seal

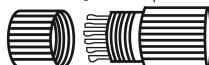

Plastic Tube Cover



Plastic Tube

Screws & wall plugs

Step1: Disassemble the camera case into three parts as illustrated in *Figure 1*.

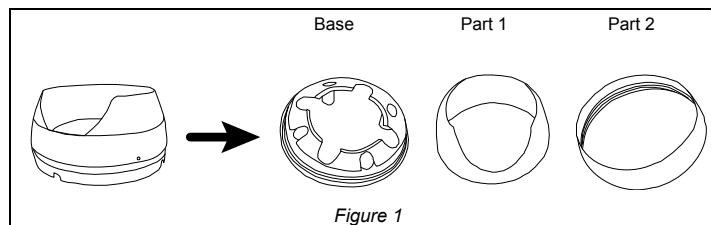

Figure 1

Step2: Locate where you want to install this camera (wall or ceiling), and drill holes on the wall or ceiling for securing the bracket and routing the cables (if necessary).

Step3: Attach the bracket to the wall (or ceiling), and make sure the cables are routed and arranged properly in the bracket, as shown in *Figure 2*.

Step4: Secure the bracket to the wall (or ceiling), as shown in *Figure 3*.

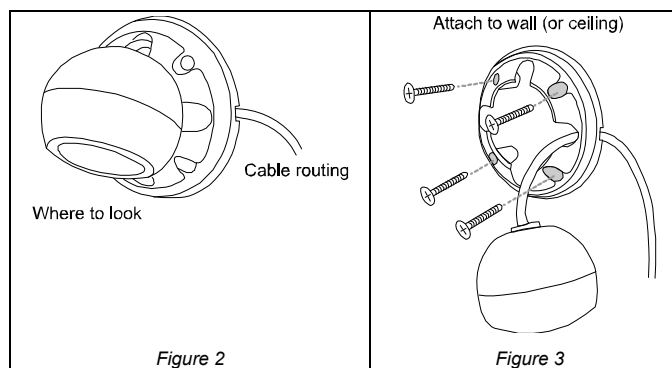

Figure 2

Figure 3

Step5: Slightly adjust the camera lens to where it's supposed to face, and replace Part 1 and Part 2 back, as shown in *Figure 4* and *Figure 5*.

Note: Do not install the lens opposite down. (Refer to *Figure 6*)

Step6: Power on the camera and fine-tune the viewing angle.

For the motorized vari-focal type, please go to the section, "**ADJUST FOCAL LENGTH & FOCUS**", to know how to adjust focal length and focus remotely.

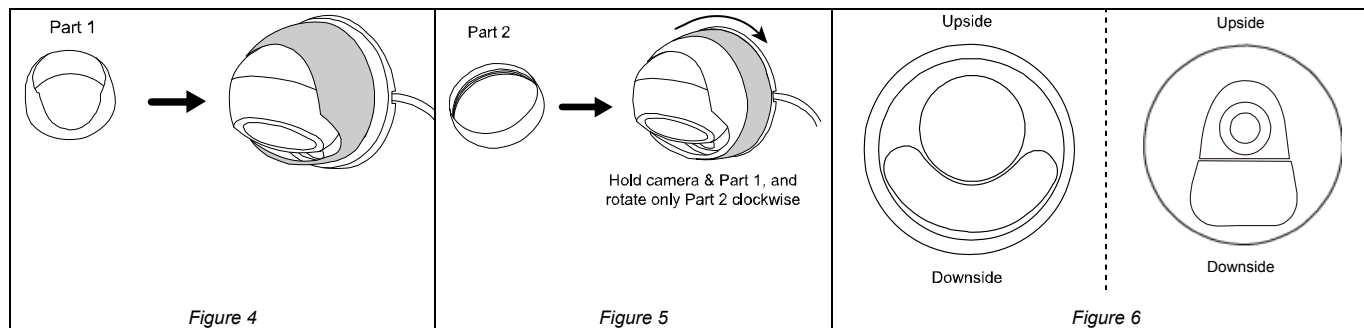

Figure 4

Figure 5

Figure 6

■ CABLE

Cable	Description
Power cable	DC12V power supply.
RJ45 network cable*	Connect it to a RJ45 cable.
GND**	Used with external alarm device connection or hardware reset.
RESET	Depending on the model you have, RESET could be one wire or a button. For the wire type, remove the insulating coating of the wire, and twist it with the GND wire together to reset the camera. For the button type, simply press the button to reset the camera.
Alarm-in**	Reserved for external alarm device connection.
Alarm-out**	
Line-in**	Colored as blue, used to connect to a microphone for audio input.
Line-out**	Colored as green, used to connect to a speaker for audio output.

* For PoE (IEEE802.3af) installation, make sure your network cable has the maximum cable resistance of 20Ω, such as CAT.5e or CAT.6 cables, to conform to the standard of IEEE802.3af.

** Optional

■ DEFAULT VALUES

IP address	192.168.1.10
Port number	88
User name	admin
Password	admin

It's strongly recommended to change the default user name and password before using the camera to keep your account safe.

To change the default account, log into the camera, and go to **Config.** → **General** → **Account**. You can create a new account and remove the default one if needed.

■ ADJUST FOCAL LENGTH & FOCUS *(For motorized-lens models only)*



To remotely adjust focal length and focus of the camera, access the camera from Internet Explorer.

Note: The default camera IP address is 192.168.1.10, the port number is 88, and the user name and password are both admin.

To search the IP address and port number, you could download our IP scan tool from

www.surveillance-download.com/user/m5447.swf

In the tab of "Live View", you'll see the icons in the control panel area as below:

	Zoom Tele / Zoom Wide	Click to zoom in on the image to the largest / zoom out on the image to its original size.
	Max Zoom Tilt / Max Zoom Wide	Click to zoom in / out the image.
	Focus Far / Near	Click to adjust the focus of the image.

Note: You can also adjust the focal length and the focus by accessing to the recorder with PTZ controlling. For more details, please refer to your recorder's manual.

■ WATERPROOF KIT *(For selected models only)*

For network cable

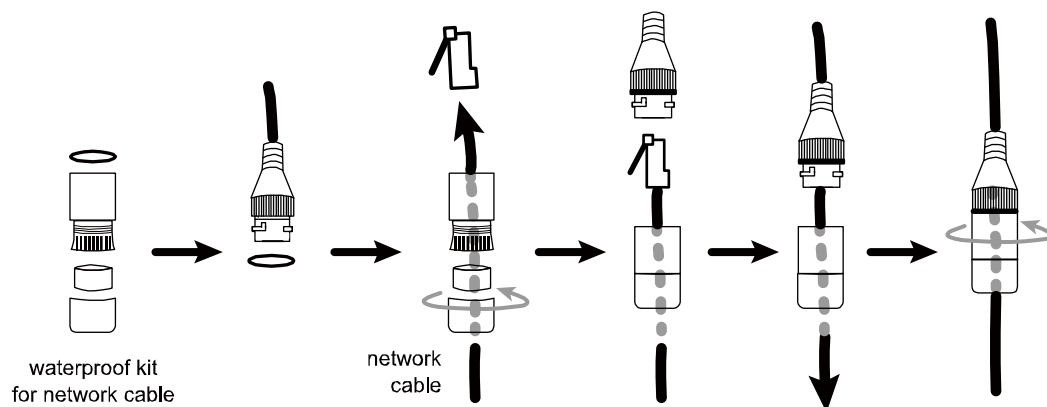

■ INSERT A MICRO SD CARD *(For Type 2 only)*

The data originally saved in the microSD card (if any) will be removed after inserting it to the camera.

The camera doesn't support hot-swapping. Please insert or remove the microSD card with power disconnected.

Please follow the directions in the below graphic to insert MicroSD card properly:

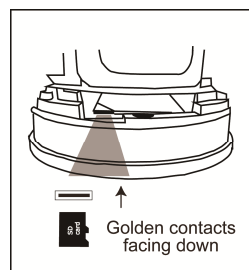

Free CMS
(CMS Lite)



Complete
User Manual